



Manor Way

Borehamwood, WD6 1BX

£319,950 Leasehold - Share of Freehold

A wonderful two bedroom, two bathroom top floor apartment in the Gemini Park development, favorably located within short access to the high street and mainline train station. The property offers an open plan living/kitchen which has access out on to the huge balcony, two double bedrooms with en-suite to the master and a contemporary bathroom. The property further benefits from underground parking, a plethora of storage. lift access and beautiful communal gardens. The apartment has no upper chain and a potential investor could expect to receive a rent of around £1,350pcm.

- Two Double Bedrooms
- Top Floor Apartment
- Two Bathrooms
- Lift
- Underground Parking
- Huge Balcony

Viewing

Please contact our Carrington Estate Agents Office on 02089531818 if you wish to arrange a viewing appointment for this property or require further information.



2



2



1



B

Floor Plan

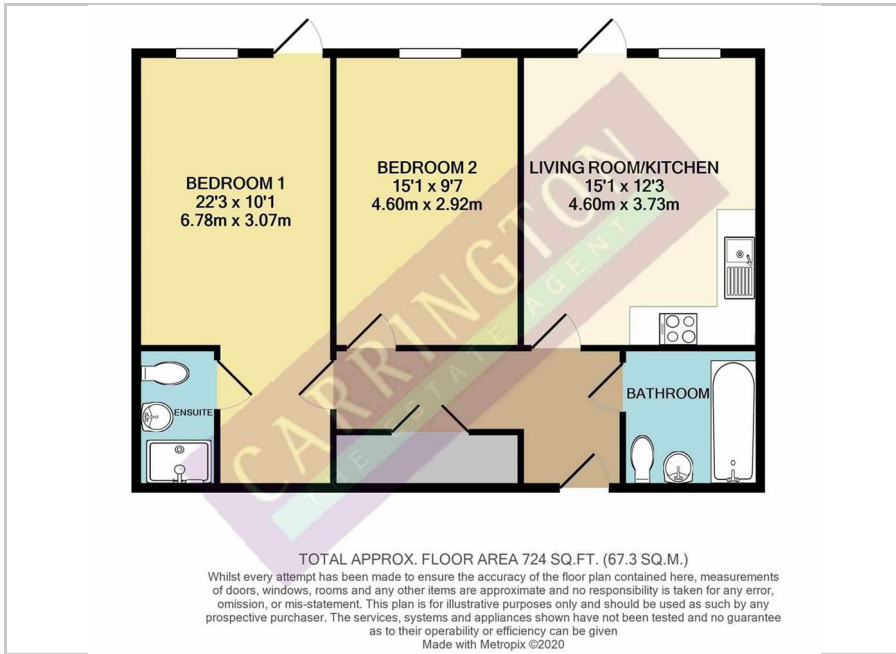

Area Map



Energy Efficiency Graph

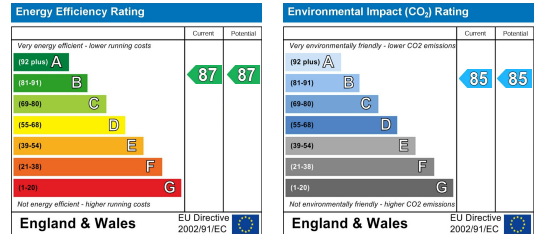

These particulars, whilst believed to be accurate are set out as a general outline only for guidance and do not constitute any part of an offer or contract. Intending purchasers should not rely on them as statements of representation of fact, but must satisfy themselves by inspection or otherwise as to their accuracy. No person in this firm's employment has the authority to make or give any representation or warranty in respect of the property.

138 Shenley Road, Borehamwood, Hertfordshire WD6 1EF
Tel: 020 8953 1818 Fax: 020 8953 0808

Email: info@carrington-borehamwood.co.uk Website: www.carrington-borehamwood.co.uk



COMPANY DIRECTOR: E. A. HUSSAIN
REGISTERED ADDRESS: 1 WARNER HOUSE, HARROVIAN BUSINESS VILLAGE,
BESSBOROUGH ROAD, HARROW, MIDD., HA1 3EX.
COMPANY REGISTRATION No: 09830132